

# PRO-flex ACF 5000\_3

## Single Phase AC Current Probe

ACF5000\_3\_081003\_07



The new PRO-flex ACF 5000\_3 is an AC current probe utilizing the Rogowski principle. It can be used to measure currents up to 5000 A from very low frequencies to 10kHz.

The flexible and lightweight measuring head allows quick and easy installation in hard to reach areas and with large conductors.



### Electrical Characteristics

<b>Current Ranges</b>	100A / 1000A / 5000A AC RMS (selectable via rotary switch)
<b>Output Sensitivity</b>	20mV / 2mV / 0.4mV per A (AC coupled)
<b>Accuracy (at 25°C)</b>	± 1% of reading ± 0.1A (100A range) ± 1% of reading ± 1A (100A / 5000A range)
<b>Load Impedance</b>	100kΩ minimum
<b>Linearity</b>	± 0.2% of reading (10% to 100% of range)
<b>Noise</b>	80mA (100A) / 400mA (1000A / 5000A range)
<b>Bandwidth</b>	10Hz to 10kHz (-1dB)
<b>Phase Error</b>	± <1° (45 – 65Hz)
<b>Temperature Coefficient</b>	± 0.1% of reading / °C
<b>Position Sensitivity</b>	± 2% of reading
<b>External Field</b>	± 0.2% of range (with cable > 100mm from the head)
<b>Working Voltage</b> (see Safety Standards section)	1000V AC RMS or DC (Probe and Integrator) 30V max (Output)

### General Characteristics

<b>Probe and Cable Material</b>	Alcryn 2070 NC LATENE 7H2W V0
<b>Probe Cable Length</b>	610mm (24") / 915mm (36") / 1220mm (48")
<b>Probe Cable Diameter</b>	9.9mm (nominal)
<b>Cable Length</b>	2m (Probe to Integrator box)
<b>Output</b>	0.5m long lead terminated with a 6-pin male LEMO
<b>Operating Temperature Range</b>	-20 to +65°C
<b>Storage Temperature Range</b>	-40 to +75°C
<b>Operating Humidity</b>	15% to 85% (non condensing)
<b>Degree of protection</b>	IP65 Probe, IP40 Integrator module
<b>Colour</b>	RAL 120 70 75 Lemon green

AUTHORIZED DISTRIBUTOR



**POWERetc Corporation**  
Santa Clara, CA 95054  
(408) 540-3199

[www.poweretc.com](http://www.poweretc.com)  
[info@poweretc.com](mailto:info@poweretc.com)

Exclusive GMC-I PROSyS Distributor of Americas

# PRO-flex ACF 5000\_3

## Single Phase AC Current Probe



ACF5000\_3\_081003\_07

### Safety Standards

EN 61010-1:2001  
EN 61010-031:2002  
EN 61010-2-032:2002  
UL 610101, 2nd Edition, 2005-07-22  
CAN/CSA-22.2 No. 61010-1, 2nd Edition, 2004-07

1000 VRMS, Category III, 600 VRMS, Category IV, Pollution Degree 2  
(Probe and Integrator)

**Limitations** Use of the probe on uninsulated conductors is limited to 1000 V AC RMS or DC and frequencies below 1 kHz.

**Compliance** ROHS and WEEE

### Compatible Instruments

**Fluke Power Monitors** Fluke 1750, Fluke (RPM) Power Recorder

### Ordering Information

Part No.	Model
P-01.750.0	ACF 5000_3/24
P-01.750.1	ACF 5000_3/36
P-01.750.2	ACF 5000_3/48

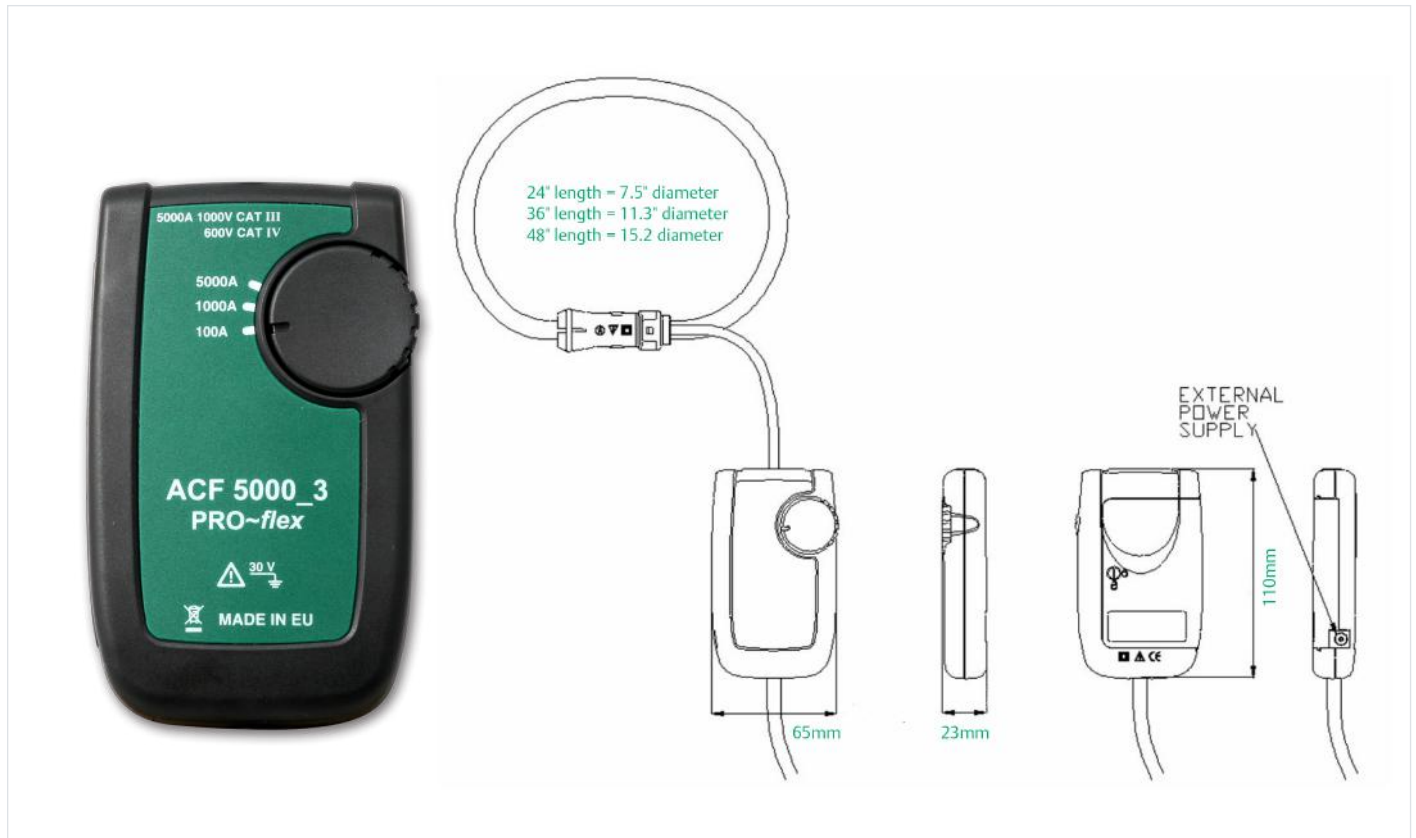

AUTHORIZED DISTRIBUTOR



**POWERetc Corporation**  
Santa Clara, CA 95054  
(408) 540-3199

[www.poweretc.com](http://www.poweretc.com)  
[info@poweretc.com](mailto:info@poweretc.com)

Exclusive GMC-I PROSyS Distributor of Americas